

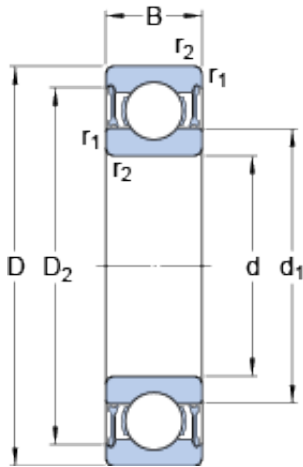

Double BALL BEARINGS CO, LTD



45 mm x 75 mm x 16 mm SKF W 6009-2RZ
deep groove ball bearings

Bearing No. W 6009-2RZ

W 6009-2RZ Bearing 2D drawings and 3D CAD models

| | |
|---|-------------|
| Size | 75x45x16 mm |
| Bore Diameter | 75 mm |
| Outer Diameter | 45 mm |
| Width | 16 mm |
| d | 45 mm |
| D | 75 mm |
| B | 16 mm |
| d ₁ | 54.5 mm |
| D ₂ | 69 mm |
| r _{1,2} - min. | 1 mm |
| D _a - max. | 70 mm |
| r _a - max. | 1 mm |
| Basic dynamic load rating - C | 18.2 kN |
| Basic static load rating - C ₀ | 15 kN |
| Fatigue load limit - P _u | 0.64 kN |
| Reference speed | 20000 r/min |
| Limiting speed | 10000 r/min |
| Calculation factor - k _r | 0.03 |
| Calculation factor - f ₀ | 15.3 |
| d ₁ | 54.5 mm |
| D ₂ | 69 mm |
| r _{1,2} min. | 1 mm |
| d _a min. | 50 mm |
| d _a max. | 54 mm |



Double BALL BEARINGS CO, LTD

| | |
|--------------------------------|---------|
| D_a max. | 70 mm |
| r_a max. | 1 mm |
| Basic dynamic load rating C | 18.2 kN |
| Basic static load rating C_0 | 15 kN |
| Fatigue load limit P_u | 0.64 kN |
| Calculation factor k_r | 0.03 |
| Calculation factor f_0 | 15.3 |
| Mass bearing | 0.24 kg |