

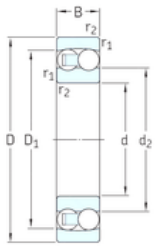

# Double BALL BEARINGS CO, LTD



Cylindrical bore



Tapered bore

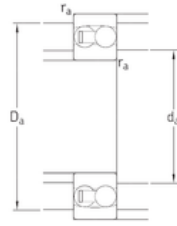

35 mm x 72 mm x 17 mm SKF 1207ETN9 self aligning ball bearings

Bearing No. 1207ETN9

1207ETN9 Bearing 2D drawings and 3D CAD models

Size	35x72x17 mm
Bore Diameter	35 mm
Outer Diameter	72 mm
Width	17 mm
d	35 mm
D	72 mm
B	17 mm
C	17 mm
d2	47 mm
r1 min.	1,1 mm
r2 min.	1,1 mm
D1	62,3 mm
da min.	42 mm
Da max.	65 mm
ra max.	1,1 mm
Weight	0,32 Kg
Basic dynamic load rating (C)	19 kN
Basic static load rating (C0)	6 kN
Fatigue load limit (Pu)	0,31
Reference speed	20000 r/min
Limiting speed	13000 r/min
Calculation factor (e)	0,23
Calculation factor (kr)	0,04
Calculation factor (Y0)	2,8
Calculation factor (Y1)	2,7



# Double BALL BEARINGS CO, LTD