

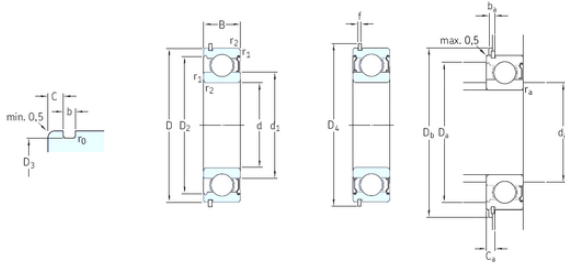

Double BALL BEARINGS CO, LTD



35 mm x 72 mm x 17 mm SKF 6207-ZNR deep groove ball bearings

Bearing No. 6207-ZNR

6207-ZNR Bearing 2D drawings and 3D CAD models

Size	35x72x17 mm
Bore Diameter	35 mm
Outer Diameter	72 mm
Width	17 mm
d	35 mm
D	72 mm
B	17 mm
C	17 mm
b	1,9 mm
d1	46,9 mm
f	1,7 mm
r0 max.	0,6 mm
r1 min.	1,1 mm
r2 min.	1,1 mm
C	3,28 mm
D2	62,7 mm
D3	68,81 mm
D4	78,6 mm
ba min.	4,98 mm
Ca max.	4,98 mm
da min.	2,2 mm
da max	46,8 mm
Da max.	65 mm
Db min.	80 mm
ra max.	1 mm



Double BALL BEARINGS CO, LTD

Weight	0,3 Kg
Basic dynamic load rating (C)	27 kN
Basic static load rating (C0)	15,3 kN
Fatigue load limit (Pu)	0,655
Reference speed	20000 r/min
Limiting speed	13000 r/min
Calculation factor (f0)	14
Category	Single Row Ball Bearings
Inventory	0.0
Manufacturer Name	SKF
Minimum Buy Quantity	N/A
Weight / Kilogram	0.31
EAN	7316575801847
Product Group	B00308
Enclosure	1 Metal Shield
Precision Class	ABEC 1 ISO P0
Maximum Capacity / Filling Slot	No
Rolling Element	Ball Bearing
Snap Ring	Yes
Internal Special Features	No
Cage Material	Steel
Internal Clearance	C0-Medium
Inch - Metric	Metric
Long Description	35MM Bore; 72MM Outside Diameter; 17MM Outer Race Width; 1 Metal Shield; Ball Bearing; ABEC 1 ISO P0; No Filling Slot; Yes Snap Ring; No Internal Special Features; C0-Medium Internal Clearance; Stee
Other Features	Deep Groove With Snap Ring



Double BALL BEARINGS CO, LTD

Category	Single Row Ball Bearing
UNSPSC	31171504
Harmonized Tariff Code	8482.10.50.68
Noun	Bearing
Keyword String	Ball
Manufacturer URL	http://www.skf.com
Weight / LBS	0.6724
Outside Diameter	2.835 Inch 72 Millimeter
Bore	1.378 Inch 35 Millimeter
Outer Race Width	0.669 Inch 17 Millimeter
Inner Race Width	0 Inch 0 Millimeter
d_1	46.94 mm
D_2	62.69 mm
D_3	68.81 mm
D_4	78.6 mm
r_0 max.	0.6 mm
$r_{1,2}$ min.	1.1 mm
d_a min.	42 mm
d_a max.	46.8 mm
D_a max.	65 mm
D_b min.	80 mm
b_a min.	2.2 mm
C_a max.	4.98 mm
r_a max.	1 mm
Basic dynamic load rating C	27 kN
Basic static load rating C_0	15.3 kN
Fatigue load limit P_u	0.655 kN
Calculation factor k_r	0.025
Calculation factor f_0	14
Mass bearing	0.3 kg
Snap ring	SP 72